



VENTILATION

**BERG'S SUPERIOR QUALITY VENTILATION FOR ALL
TYPES OF FACILITIES**



**BERG FANS ARE CONSTRUCTED FROM
HEAVY GALVANIZED STEEL FOR
DEPENDABLE LONG LASTING SERVICE
WITH THE FARMER IN MIND!**

BERG Equipment Corporation
2700 W. Veterans Parkway
Marshfield, WI. 54449
Phone: 715-384-2151 or 800-494-1738
Website: www.bergequipment.com



10/14/04 Rev 8



Cone Fan

4 or 6 Wing
Blade

P/N - 24-0471
36" Cone Fan
P/N - 24-0451
48" Cone Fan

Rough
Opening Height
x Width

**46" x 43"
**58" x 55"

- Use for tunnel ventilation exhaust

**Note: Height opening shown for cone fan is for a 6" thick wall, add 1/2" for every 2" thickness of wall over 6".



Basic Stir Fan

4 or 6 Wing
Blade

P/N - 24-0470
36" Basic Stir Fan
P/N - 24-0450
48" Basic Stir Fan

- Hang with chains or Hanger tube mount to a building column
- Open free flow design



Stir Box Fan

4 or 6 Wing Blade

P/N - 24-0473
36" Stir Box Fan
P/N - 24-0453
48" Stir Box Fan

- Hang with chains or hanger tube mount
- Box fans can easily be adapted for parlor intake fans or tunnel ventilation exhaust

*Note: Stir Box Fans and Basic Stir Fans can not be wall mounted and must be at least 8'6" above working floor.



Wall Box Fan

4 or 6 Wing
Blade

*P/N - 24-0922
24" Wall Box Fan
P/N - 24-0472
36" Wall Box Fan

P/N-24-0452
48" Wall Box Fan

Rough Opening
Height x Width

29" x 29"
43" x 43"
55" x 55"

- Box fans can easily be adapted for parlor intake fans or tunnel ventilation exhaust

*Note: 24" fan only available in 6 wing blade.



Cattle Guard Features:

- Angle iron and 1/2" re-bar construction
- Available for the following size fans:
24" - 24-0932
36" - 24-0933
48" - 24-0418

Additional Options For 48" Fans:

24-0440 - 6 Blade Exchange Option *Heavy Construction
24-0221 - 2 Speed Motor Exchange (1 HP/230V)

Additional Options For The 36" Fan:

24-0441 - 6 Blade Exchange Option *Heavy Construction
24-0224 - 2 Speed Motor Exchange (1/2 HP/115V)
• 3 Phase-Single Speed Motors Are Available On Most Models
• Time And Temperature Controls

Barron Warehouse
1303 South 18th St.
Barron, WI 54812
Phone: 715-537-9276

Mounting Options:



24-0488
Style 4G Fan Hanger Tube

24-0487
Style 4L Fan Hanger Tube

(Tubes only, hardware sold separately)

Berg's Fans Come Standard With:

- 36" - 1 Speed - 1/2 HP (115/230V) Motor
- 48" - 1 Speed - 1 HP (115/230V) Motor



Floor Fan

P/N - 24-0439
ASSY F481 Floor Fan



- Portable, can easily be moved and placed in different parts of the building to circulate air
- Sturdy design for years of use
- Large rubber wheels for ease of mobility

Small Exhaust Fan



P/N - 23-0314
16" Exhaust Fan
P/N - 23-0324
18" Exhaust Fan
P/N - 23-0340
20" Exhaust Fan

Rough Opening
Height x Width

22 1/4" x 22 1/4"
22 1/4" x 22 1/4"
27" x 27"

- Can be used in compressor rooms to exhaust excess heat
- Wire guards to protect blades

Berg Fresh Air Intakes & Vents

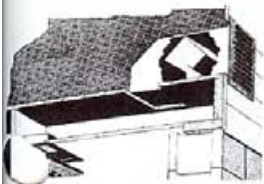

24-0530 - #1 Air Intake
9 1/2" high & 10 1/2" wide. To be installed on top of floor or between joists.



24-0532 - #3 Air Intake 7 1/2" high & 16" wide. Displaces 1-8" x 16" building block.

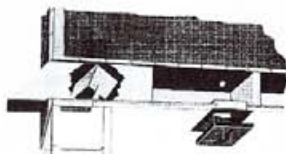

24-0531 - #2 Air Intake 7 1/2" high & 13 1/4" wide. To be installed on top of floor or between joists.



24-0536 - Air Vent
7 1/2" high & 13" wide



24-0533 - #4 Air Intake
Designed for installation in ceiling of one story barns.

**HIGH EFFICIENCY
VENTILATION FROM BERG!**

Berg Equipment Investment LTD.
1455 Creamery Rd.
London, Ontario, Canada N5V 5B3
Phone: 519-455-4780



Here Are Just A Few Of The Reasons To Buy Ventilation From BERG EQUIPMENT

- All Fans Include:
 - Automatic Belt Tightener
 - Greasable Bearings
 - Cast Pulleys
 - A Heavy Blade Mounted In A Heavy Spun Galvanized Steel Venturi
- Keeps Cows Cool So They Eat More & Helps Maintain Your Milk Production
- Healthier Cows Equal Higher Profits
- Air Flow Dries Feed Alleys & Reduces Feed Spoilage
- Gets Rid Of Flies, Heat, Humid Air, Dust, Disease Organisms & Ammonia Odor

Berg Equipment Fan Technical Data

(CFM & RPM TAKEN FROM ACME ENGINEERING DATA)

| FAN | BLADE | MOTOR | CFM @ Free air | CFM @ .05 | RPM | AMP @ 115V |
|-----|-------|--------|-------------------|-----------|-----|------------|
| 24" | 6 | 1/3 HP | 5,968 | 5,729 | 735 | 7.2 |
| 24" | 6 | 1/2 HP | 6,285 | 6,285 | 820 | 9.8 |
| 24" | 6 | 3/4 HP | 7,978 | 7,754 | 949 | 13.8 |
| 36" | 4 | 1/2 HP | 12,360 | 11,800 | 634 | 9.8 |
| 36" | 6 | 1/3 HP | 10,456 | 9,551 | 431 | 7.2 |
| 36" | 6 | 1/2 HP | 12,072 | 11,375 | 495 | 9.8 |
| 36" | 6 | 3/4 HP | 14,028 | 13,425 | 575 | 13.8 |
| 36" | 6 | 1 HP | 14,878 | 14,335 | 634 | 16 |
| 48" | 4 | 1 HP | 23,800 | 22,700 | 473 | 16 |
| 48" | 6 | 1 HP | 22,337 | 21,011 | 382 | 16 |

(FOR 230 VOLT-AMP DRAW IS HALF OF THAT SHOWN)



With the comfort from
Berg's Fans I Never Want
to MOOOOOVE!

Our goal at BERG Equipment is to provide superior quality
ventilation for all types of livestock facilities at an economical cost.

BERG-Bennett Inc.
RD 2, Box 113C
Wysox, PA 18854
Phone: 570-265-7119 or
Toll Free: 800-724-4866